

# HE ANIUM Straight Eyelets ES

Our standard straight eyelets **ES** are listed below. The outside diameter **D** identifies each part for easy reference. Custom parts with tailored OD, ID, or length are available. Additional standard and custom parts are available. Contact our **technical sales** department for assistance.

PART NUMBER	INSIDE DIAMETER		OVERALL LENGTH		OUTSIDE DIAMETER	
	<b>B</b>		<b>C</b>		<b>D</b>	
	INCHES	MM.	INCHES	MM.	INCHES	MM.
ES-218-2	0.125	3.2	0.250	6.4	0.218	5.5
ES-250	0.062	1.6	0.187	4.7	0.250	6.4
ES-275	0.156	4.0	0.093	2.4	0.275	7.0
ES-315	0.171	4.3	0.125	3.2	0.315	8.0
ES-356	0.203	5.2	0.156	4.0	0.356	9.0
ES-375-4	0.312	7.9	0.250	6.4	0.375	9.5
ES-397	0.218	5.5	0.140	3.6	0.397	10.1
ES-475	0.359	9.1	0.125	3.2	0.475	12.1
ES-619	0.250	6.4	0.406	10.3	0.619	15.7
ES-1250	0.750	19.1	0.343	8.7	1.250	31.8

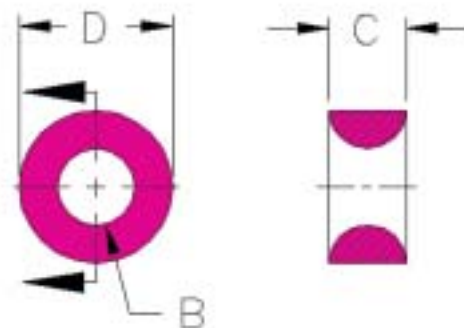

PART NUMBER	REPLACES G-RING (Carbide)	INSIDE DIAMETER		OVERALL LENGTH		OUTSIDE DIAMETER	
		<b>B</b>		<b>C</b>		<b>D</b>	
		INCHES	MM.	INCHES	MM.	INCHES	MM.
ES-0234-G1	G1	0.140	3.6	0.093	2.4	0.234	5.9
ES-275	G2	0.156	4.0	0.093	2.4	0.275	7.0
ES-0312-G3	G3	0.187	4.7	0.093	2.4	0.312	7.9
ES-397	G5	0.218	5.5	0.140	3.6	0.397	10.1
ES-0421-G6	G6	0.298	7.6	0.125	3.2	0.415	10.5
ES-475	G7	0.359	9.1	0.125	3.2	0.475	12.1
ES-590	G8	0.437	11.1	0.171	4.3	0.590	15.0
ES-675	G9	0.515	13.1	0.171	4.3	0.675	17.1
ES-912	G10	0.695	17.7	0.230	5.8	0.912	23.2

**PART NUMBERING:** Our part numbering system allows quick-and-easy part selection using the functional outside diameter or width of the part. These dimensions are highlighted throughout this catalog for easy reference.

**TOLERANCES:** Standard tolerances on Heanium components are .010 inch or  $\pm 1.5\%$ , whichever is greater. Dimensions on parts can be held to tighter tolerances as required, utilizing diamond grinding and honing.

# HEANIUM Grooved Eyelets **EG**

Our standard grooved eyelets **EG** are listed below. The outside diameter **D** identifies each part for easy reference. Most Heanium grooved eyelets can be provided with slots for self-threading. Custom parts with tailored OD, ID, or length are available. Additional standard and custom parts are available. Contact our **technical sales** department for assistance.

PART NUMBER	INSIDE DIAMETER		OVERALL LENGTH		OUTSIDE DIAMETER		GROOVE RADIUS	
	<b>B</b>		<b>C</b>		<b>D</b>			
	INCHES	MM.	INCHES	MM.	INCHES	MM.	INCHES	MM.
<b>EG-315</b>	0.140	3.6	0.165	4.2	0.315	8.0	0.031	0.8
<b>EG-430*</b>	0.234	5.9	0.180	4.6	0.430	10.9	0.059	1.5
<b>EG-460*</b>	0.187	4.7	0.406	10.3	0.460	11.7	0.120	3.0
<b>EG-0510-01</b>	0.296	7.5	0.230	5.8	0.510	12.9	0.115	2.9
<b>EG-680*</b>	0.234	5.9	0.312	7.9	0.680	17.2	0.125	3.2
<b>EG-680-1*</b>	0.375	9.5	0.312	7.9	0.680	17.3	0.125	3.2
<b>EG-1250</b>	0.770	19.6	0.335	8.5	1.250	31.8	0.125	3.2

\* These items can be provided pre-assembled with the shanks listed below.

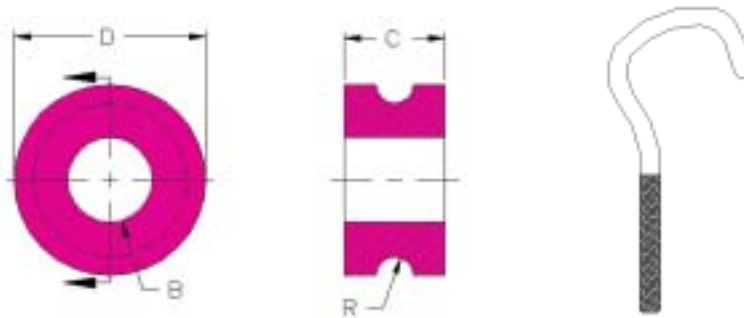

SHANK NUMBER	HEANY P/N	THREAD SIZE	SHANK OD		THREAD LENGTH		OVERALL LENGTH	
			<b>C</b>		<b>D</b>		<b>E</b>	
			INCHES	MM.	INCHES	MM.	INCHES	MM.
<b>ESH-01</b>	EG-430, EG-460	PLAIN	0.125	3.2	N/A	N/A	3.250	82.6
<b>ESH-02</b>	EG-680, EG-680-1	PLAIN	0.125	3.2	N/A	N/A	3.500	88.9
<b>ESH-03</b>	EG-430, EG-460	6/32	0.138	3.5	1.500	38.1	2.275	57.8
<b>ESH-04</b>	EG-430, EG-460	8/32	0.153	3.9	1.290	3.3	2.250	57.2
<b>ESH-05</b>	EG-680, EG-680-1	10/24	0.187	4.7	1.500	38.1	2.375	60.3
<b>ESH-06</b>	EG-680, EG-680-1	10/24	0.187	4.7	1.788	45.4	3.000	76.2
<b>ESH-07</b>	EG-680, EG-680-1	10/32	0.187	4.7	1.000	25.4	2.175	55.2
<b>ESH-08</b>	EG-680, EG-680-1	10/32	0.187	4.7	1.788	45.4	3.000	76.2

**ADAPTABLE MOUNTING:** Heanium parts can be assembled with various fittings and hardware. Mountings, shanks, casings, bushings, and bearings enable Heanium parts to be readily installed on machinery. In-house machining capabilities allow us to manufacture customized mounting holders for your special needs. Contact our **technical sales** department for assistance.

Standard finish (Ra) on all surfaces is 64 µin. Polishing to 32 µin (**P2 Polish**) or 16 µin (**P1 Polish**) is available.